



SHOWGUIDE

SIoux FALLS, SD

MARCH 1-3, 2024



SHOW HIGHLIGHTS

SHOW FLOOR MAP

EXHIBITOR LISTING

SEMINAR SCHEDULES

PURINA
PRO PLAN

“ I BELIEVE IN THE SCIENCE.
I BELIEVE IN THE RESULTS
I HAVE SEEN OVER DECADES.
AND THAT’S WHY WE FEED
PURINA PRO PLAN. ”

— Ronnie Smith,
Co-owner of Smith Kennels
Pawhuska, OK



OFFICIAL DOG FOOD OF

Smith
KENNELS
Est. 1956

ProPlanSport.com EXCLUSIVELY AT PET SPECIALTY AND ONLINE RETAILERS

Purina trademarks are owned by Société des Produits Nestlé S.A. Any other marks are property of their respective owners.



Your Pet, Our Passion.®

A SPECIAL THANK YOU TO OUR 2024 SHOW SPONSORS

PRESENTING SPONSOR



DIAMOND SPONSORS



GOLD SPONSORS



SILVER SPONSORS



BRONZE SPONSORS



PHEASANTFEST.ORG



COVER ART BY DUSTIN SINNER
dustinsinner.com



- 4 - 5**
Public Lands Pavilion & Schedule
- 6**
Public Access to Habitat (P.A.T.H.)
- 8 - 9**
Bird Dog Stage & Schedule
- 10 - 11**
Path to the Uplands & Schedule
- 12 - 13**
Youth Village & Family Day
- 14 - 15**
Habitat Help Desk & Schedule
- 16**
PF & QF Elite Membership
- 18**
Women on the Wing
- 20 - 21**
Exhibitor Listing
- 22 - 23**
Show Floor Map
- 24**
Show Floor Raffles
- 26**
50-50 Raffle & Online Auction
- 28**
Technical Poster Sessions
- 30**
Pollinator Pathway

The Pheasants Forever and Quail Forever mission is to conserve pheasants, quail and other wildlife through habitat improvements, public access, education and conservation advocacy.

Welcome to the world's biggest and best show for upland hunters and wildlife lovers, habitat conservationists of all descriptions, bird dog fans and outdoor families. Pheasants Forever and Quail Forever is excited to be back in the pheasant capital — South Dakota — for 2024!

GRASSROOTS MODEL

At the heart of The Habitat Organization is our unique model empowering Pheasants Forever and Quail Forever chapters with 100 percent decision-making control over their locally raised funds. We are the only national conservation organization that operates through this unique and truly grassroots structure. Local chapter volunteers conduct wildlife habitat projects and conservation events while belonging to a national organization with a powerful voice regarding federal and state conservation policy.

WILDLIFE HABITAT

Since Pheasants Forever's inception

in 1982 and Quail Forever's launch in 2005, the organization has impacted more than 26.5 million acres across 580,400+ habitat projects: nesting and brood-rearing cover, upland prairie and wetland restorations, food and cover plots, winter cover and more. Our employees, chapters and partners drive this work. In 2023 alone, The PF & QF wildlife biologist team made 37,728 landowner contacts, leading to more than 1.77 million acres of voluntary habitat improvement for wildlife. Chapters spearheaded on-the-ground projects spanning 65,234 acres.

PERMANENT PROTECTION

Many members put high value on the creation of new, permanently public lands for wildlife and recreation. In 2023, Pheasants Forever and Quail Forever added 4,463 acres of land acquisitions, making for a grand total of 229,846 acres of permanently protected habitat since 1982. These permanent protection

projects have been completed in conjunction with local, state and federal resource agencies, as well as our chapters in many cases. Every acre has been conveyed to state and federal natural resource agencies, and every single acre is open to public hunting.

PUBLIC ACCESS

Permanently protected lands are not the only source of public-access acres for hunting. Hundreds of thousands of acres of private lands that Pheasants Forever and Quail Forever help restore into wildlife habitat are in turn enrolled in state walk-in access programs.

CONSERVATION ADVOCACY

From the backcountry to the back 40, our habitat mission is directly tied to a strong framework of federal and state conservation programs, such as the Conservation Reserve Program (CRP). Through our Government Affairs Team, we act as the voice for upland habitat in Washington D.C. as well as state houses across the pheasant and quail range.

CONSERVATION EDUCATION

The Habitat Organization's conservation education team and chapters are dedicated to sharing outdoor lifestyles and an appreciation for wildlife, while inspiring traditional, new and emerging audiences of all ages.

Over the past year, Pheasants Forever hosted 1,258 events impacting 21,250 youth participants and 33,597 adult participants; Quail Forever hosted 926 events impacting 6,382 youth participants and 24,209 adult participants.

RESTORATION AND ENHANCEMENT

Employing restoration specialists, habitat strike teams and other team members to address habitat needs on public and private lands, Pheasants Forever and Quail Forever restored or enhanced a whopping 655,336 acres across America's pheasant and quail ranges in 2023. Examples of these projects: cedar and juniper removal in grasslands and sagebrush, prescribed fire, addressing invasive species, and chapter Adopt-A-Game-Area projects.

JOIN US

Pheasants Forever and Quail Forever invite you to join our mission to ensure a landscape rich in upland wildlife habitat, and filled with public-access places for people to enjoy the resource. Consider increasing your support

with a visit to our Elite Member booth. Join PF or QF, or renew your membership, at the show. Join your local chapter ... or start one. The future of our magnificent uplands depends on you.

ENJOY THE SHOW!



Thank You to SCHEELS for providing team uniforms for the 2024 National Pheasant Fest & Quail Classic. Team members wearing these uniforms will be able to provide assistance and answer your questions during the three-day event.



Connect with our employee team online at pheasantsforever.org/employees

FEATURED SPEAKERS

PUBLIC LANDS PAVILION

SPONSORED BY



AND SEMINAR STAGE SCHEDULE

The Public Lands Pavilion features an exciting lineup of dynamic speakers and an exhibitor area celebrating the country's **800 million acres** of prairies, forests, mountains and public lands open to all Americans for hunting, hiking and exploring.

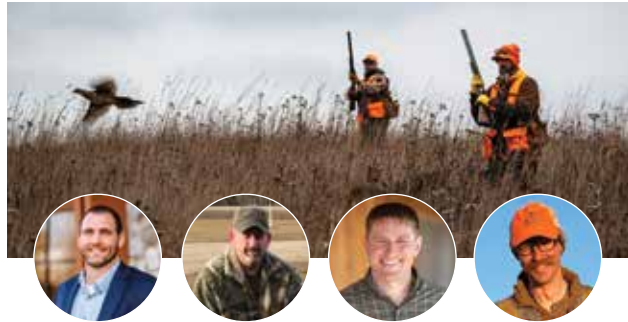

SOUTH DAKOTA STATE-OF-THE-STATE IN THE NATION'S PHEASANT CAPITAL

With a pheasant hunting harvest averaging more than 1 million roosters annually, there is no doubt South Dakota holds the distinction as our nation's Pheasant Capital. Hear about the work being done to improve habitat for pheasants and create more access for public land hunters. The panel includes: Kevin Robling, South Dakota Game, Fish & Parks Department Secretary; Todd Frerichs, U.S. Fish & Wildlife Service; and Matt Gottlob, PF's South Dakota State Coordinator. Moderated by Ryan "Cal" Callaghan, MeatEater's Director of Conservation.



ASK THE EDITORS PUBLIC LAND HUNTING TIPS & TRICKS

Join a trio of editors representing three of the largest publications in the uplands for a conversation about public land bird hunting tips covering the pheasant range of the Midwest to the quail range of the Great Plains to mixed-bag adventures in the West. The panel includes: Tom Carpenter, Pheasants Forever Journal Editor; Ryan Sparks, Quail Forever Journal Editor; and Kali Parmley, Gun Dog Magazine Editor. Moderated by MeatEater's Ryan "Cal" Callaghan.



P.A.T.H.: SOUTH DAKOTA'S NEWEST ACCESS PROGRAM FOR PUBLIC LAND HUNTERS

In South Dakota, Pheasants Forever has expanded the successful model of community-based conservation with the launch of its Public Access to Habitat (P.A.T.H.) initiative. Panel members will discuss the program, landowner enrollment options, and how to find available properties. The panel includes: Kevin Robling, South Dakota Game, Fish & Parks Department Secretary; Ben Brettingen, onX Hunt; Sam Soholt, Public Land Tees; and Jake Hanson, PF's Director of Development in South Dakota. Moderated by MeatEater's Ryan "Cal" Callaghan.

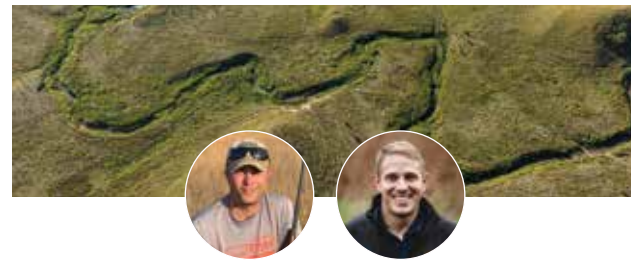

PUBLIC LAND CREATORS

Since the organization's 1982 creation, PF & QF has helped create 229,846 acres of public land for wildlife and hunters. Additionally, PF & QF's efforts have helped expand state walk-in programs throughout the country. This exciting session will pull back the curtains on the variety of ways The Habitat Organization is working to create more access for the public land bird hunter. Presenters include: John Laux, PF & QF's Permanent Habitat Protection Programs Manager; and Eric Sytsma, PF & QF's Habitat Protection Officer.

	TIME	TOPIC	SPEAKER(S)
FRIDAY	12:30	Prairie Grouse in the Dakotas	North American Grouse Partnership
	1:00	Hunter Access on America's Public Lands	Moderated by Ariel Wiegard
	2:00	Ruffed Grouse & Woodcock Hunting	Ruffed Grouse Society
	3:00	Public Land Creators with PF & QF	John Laux & Eric Sytsma (PF & QF)
	4:00	Quail Coast-to-Coast Panel	Moderated by Andy Edwards (QF)
	5:00	A Guide to Pheasant Hunting Public Lands	Keng Yang
	5:30	Public Access to Habitat Panel	Moderated by MeatEater's Ryan "Cal" Callaghan
	6:30	P.A.T.H. Happy Hour	Leinenkugel's, YETI, South Dakota Game Fish & Parks and onX Hunt
SATURDAY	10:30	Prairie Grouse in the Dakotas	North American Grouse Partnership
	11:00	Ask the Editors for Public Land Hunting Tips & Tricks	Tom Carpenter, Kali Parmley, Ryan Sparks
	12:00	Public Land Creators with PF & QF	John Laux & Eric Sytsma (PF & QF)
	1:00	Quail Coast-to-Coast Panel	Moderated by Andy Edwards (QF)
	2:00	DIY Sage Grouse	Michael Peyton
	2:30	Ruffed Grouse & Woodcock Hunting	Ruffed Grouse Society
	3:00	South Dakota State of the State in the Pheasant Capital	Moderated by MeatEater's Ryan "Cal" Callaghan
	4:00	A Guide to Pheasant Hunting Public Lands	Keng Yang
4:30	Public Access to Habitat Panel	Moderated by MeatEater's Ryan "Cal" Callaghan	
	5:30	P.A.T.H. Happy Hour	Leinenkugel's, YETI, South Dakota Game Fish & Parks and onX Hunt
SUNDAY	11:00	Quail Coast-to-Coast Panel	Moderated by Andy Edwards (QF)
	12:00	A Guide to Pheasant Hunting Public Lands	Keng Yang
	12:30	DIY Sage Grouse	Michael Peyton
	1:00	Public Land Creators with PF & QF	John Laux & Eric Sytsma (PF & QF)
	2:00	Prairie Grouse in the Dakotas	North American Grouse Partnership
	2:30	Ruffed Grouse & Woodcock Hunting	Ruffed Grouse Society



PHEASANTS FOREVER'S PUBLIC ACCESS TO HABITAT

This past fall, Pheasants Forever proudly announced a new outdoor access initiative with the goal of enrolling 10,000 acres per year in South Dakota. The Public Access to Habitat (P.A.T.H.) program accelerates the statewide enrollment of lands in long-term conservation programs while bolstering participation in South Dakota Game, Fish and Parks' (GFP) Walk-In Area (WIA) program. The inaugural year, fully funded at \$250K through national sponsors onX Hunt and South Dakota Tourism, opened enrollment to landowners starting on September 1, 2023.

Additive to the current GFP Walk-In Area program and administered in a similar manner, P.A.T.H. provides an additional sign-up incentive of up to \$25 per acre, paid in advance, in return for 10 years of undisturbed habitat and hunting access on private lands. Landowners work directly with biologists from Pheasants Forever or GFP for site evaluation and implementation, following approval from a review panel. When combined with other financial incentives (signing bonus and payment for walk-in access plus conservation program payment), P.A.T.H. enrollments pay landowners a competitive rate for a decade of habitat stewardship and hunting access.



PUBLIC LANDS PAVILION P.A.T.H. SUPPORTERS

As part of the Public Lands Pavilion, we'll be raising funds for our Public Access To Habitat (P.A.T.H.) program. P.A.T.H. provides an additional sign-up incentive (\$25 per acre) for landowners to open quality habitat to public recreation. Consequently, each \$25 donation will result in a new acre of public access, and every \$250 contribution leads to 10 new acres of access. As part of the Public Lands Pavilion, the following businesses have agreed to donate 10% of their revenue to our P.A.T.H. program to open more public access in South Dakota:



SCAN TO LEARN MORE OR TO SUPPORT P.A.T.H.
pheasantsforever.org/path



FEATURED SPEAKERS

BIRD DOG STAGE

SPONSORED BY



AND SEMINAR SCHEDULE

The world's best dog trainers are at the 2024 National Pheasant Fest & Quail Classic Bird Dog Stage! Everybody loves their bird dog, and this is always one of the most popular places at Pheasant Fest. Learn from the experts!



RONNIE & SUSANNA SMITH

Ronnie Smith's life has revolved around bird

dogs and the family business of raising and training some of the best bird dogs in the country at Ronnie Smith Kennels LLC, located in northeastern Oklahoma. Since 1982, Smith has been giving seminars across the country, helping people to better understand their dogs and how to interact with each individual breed, building his distinction as a premier dog trainer.



DR. RUTHANN LOBOS

RuthAnn Lobos (@VetLobos), DVM CCRT CCVAT,

currently serves as a senior veterinarian for Nestle' Purina PetCare, dedicating her career to helping advance the science of nutrition for pets to live better, longer lives. Residing in Boulder, Colorado, she spends her evenings and weekends practicing as a relief veterinarian. Outside of work, Dr. Lobos enjoys fly fishing, working with sporting dogs and upland bird hunting, and co-hosts PF & QF's "Ask a Vet" series in partnership with Purina Pro Plan.



DR. SETH BYNUM

An Idaho-based veterinarian, avid wingshooter

and former journalist, DVM Seth Bynum (@birddogvet) specializes in canine reproduction and serves as adjunct faculty at Washington State University. Fond of using both shotgun and camera in the uplands behind his German shorthairs, Dr. Bynum is also a contributing writer and photographer for MeatEater and writes and co-hosts PF & QF's "Ask a Vet" series in partnership with Purina Pro Plan.



RICK SMITH

Rick Smith is a renowned field trialer and trainer, is a Brittany Hall of

Fame inductee and a Smith Training Seminar instructor. Cousin to Ronnie Smith and the son of legendary dog trainer Delmar Smith, Rick conducts seminars on an international scale and continues to raise his outstanding line of Brittany bird dogs. From puppyhood to finished bird dogs, Smith is at the top of his class.



TOM DOKKEN

The inventor of the DeadFowl Trainer, Tom has more than 40 years of training

experience. He owns Dokken's Oak Ridge Kennels, the largest gun dog training kennel in the upper half of the U.S., and Dokken Dog Supply. He is the author of *Retriever Training: The Complete Guide to Developing Your Hunting Dog*, the leading innovator in shed antler hunting with dogs, and Senior ProStaff member for SportDOG Brand® and Purina.



MIKE WIEBEN

Pro trainer Mike Wieben is one of the Midwest's premier dog

trainers for shed hunting, upland hunting and waterfowling, focusing on hunting techniques as well as all-around obedience for gun dogs. Wieben is the head dog trainer with 20 years of experience at Dokken's Oak Ridge Kennels, Inc. located near Northfield, Minnesota, and is a certified NASHIDA master judge.

	TIME	TOPIC	SPEAKER(S)
FRIDAY	1:00	Training Your Dog to Find Shed Antlers	Mike Wieben
	1:30	How to Help Your Dog Find More Birds	Tom Dokken
	2:00	Puppy Prepping	Rick Smith
	2:30	Ask a Vet: What's in Your First Aid Kit	Dr. Seth Bynum & Dr. RuthAnn Lobos
	3:00	Developing a Bird Dog Puppy	Ronnie and Susana Smith
	3:30	Advanced Training for Hunting Dogs	Tom Dokken
	4:00	Strategies to Keep Your Dog Healthy While Afield	Mike Wieben
	4:30	Puppy Prepping	Rick Smith
	5:00	Core Bird Dog Behaviors and Mindsets	Ronnie and Susanna Smith
	5:30	Ask the Experts - Over 200 years of Dog Training Experience	Panel
SATURDAY	10:00	Developing a Bird Dog Puppy	Ronnie and Susana Smith
	10:30	How to Help Your Dog Find More Birds	Tom Dokken
	11:00	When Should I Spay or Neuter My Hunting Dog	Dr. Seth Bynum
	11:30	Puppy Prepping	Rick Smith
	12:00	Training Your Dog to Find Shed Antlers	Mike Wieben
	12:30	Ask-a-Vet: Get Your Questions Answered	Dr. Seth Bynum & Dr. RuthAnn Lobos
	1:00	Core Bird Dog Behaviors and Mindsets	Ronnie and Susanna Smith
	1:30	Advanced Training for Hunting Dogs	Tom Dokken
	2:00	Strategies to Keep Your Dog Healthy While Afield	Mike Wieben
	2:30	Puppy Prepping	Rick Smith
	3:00	Fueling Success - Maximizing Nutrition for your Hunting Dog	Dr. RuthAnn Lobos
	3:30	A More Natural Way to Steady Your Dog	Ronnie and Susanna Smith
	4:00	How to Help Your Dog Find More Birds	Tom Dokken
	4:30	Training Your Dog to Find Shed Antlers	Mike Wieben
5:30	Ask the Experts - Over 200 years of Dog Training Experience	Panel	
SUNDAY	10:00	Training Your Dog to Find Shed Antlers	Mike Wieben
	10:30	Core Bird Dog Behaviors and Mindsets	Ronnie and Susanna Smith
	11:00	How to Help Your Dog Find More Birds	Tom Dokken
	11:30	Ask-a-Vet: Get Your Questions Answered	Dr. RuthAnn Lobos & Dr. Seth Bynum
	12:00	Puppy Prepping	Rick Smith
	12:30	Strategies to Keep Your Dog Healthy While Afield	Mike Wieben
	1:00	A More Natural Way to Steady Your Dog	Ronnie and Susanna Smith
	1:30	Advanced Training for Hunting Dogs	Tom Dokken
	2:00	Ask the Experts - Over 200 years of Dog Training Experience	Panel

FEATURED SPEAKERS

PATH TO THE UPLANDS

SPONSORED BY



AND SEMINAR STAGE SCHEDULE

Back by popular demand, this unique stage presented by ALPS OutdoorZ serves as a platform for dynamic individuals to share their passion for the wide-open spaces and serenity that is provided by upland wildlife habitat. Different motivations drive our interest in these common grounds, but these presenters will tell a compelling story including how they got started, why they are still connected, and inspire others to get involved! For more enlightening content visit pheasantsforever.org/pathtotheuplands.



HANK SHAW

A bird in the hand is only as good as what you can do with it in the

pan! Forget cream of mystery casseroles using pheasant breasts — Hank is a James Beard Award-winning author and chef who will be sharing his best tips and tricks for making the most of your harvest. Following his talk there will be time for audience members to ask him questions about wild game cookery in general and purchase a signed copy of his book *Pheasant, Quail, Cottontail*.



BEN BRETTINGEN

Hailing from Minnesota, Ben chases upland birds from the grouse woods

of the Great Lakes to points across the country as the Wingshooting Manager for onX Hunt. Through his travels and extensive use, he has developed many strategies on how to use the Hunt App to better help hunters find success behind their dogs, for many different species. Learn much as he shares his insights into finding the best spot to locate wild, public land birds.



TYLER SLADEN

Tyler has been a falconer for about a decade, with 7 of those years

focused on chasing quail and other upland birds over bird dogs with goshawks. His talk will focus on all aspects of hunting with birds of prey. He's a professional photographer and videographer, as well as army veteran. He and his wife run a kennel of English setters, shorthairs and jagdterriers.



DOUG DUREN

Doug Duren is a passionate hunter, farmer, land manager and

conservationist. Doug manages the Duren Family Farm near Cazenovia, Wisconsin where he has been working and hunting for over 45 years. The farm has been in the Duren family for 115 years. In this session Doug will speak about hunting access and building a conservation resume, challenging hunters to explore how they can contribute most to conservation.



NICK HOFFMAN

A story about the life-changing power of outdoor mentorship,

how to find it, and how to pay it forward once you do. Join award-winning country music artist and host of Outdoor Channel's *Nick's Wild Ride* as he tells his story of growing up as a kid in a non-hunting family and struggling to find a mentor to introduce him to the hunting lifestyle. Learn ways to easily introduce and inspire others to take to the field.



DR. JENNIFER ZAVALETA CHEEK

Jennifer is an Assistant Professor at South Dakota

State University. Her research broadly focuses on human dimensions of natural resource management. As someone who loves spending time outdoors with her family, she is dedicated to increasing participation and appreciation of the natural environment. Her current research project seeks to understand how to increase women's participation and retention in hunting and fishing.

	TIME	TOPIC	SPEAKER(S)
FRIDAY	2:00	Bird Dog, Family Dog	Tom Carpenter (PF)
	2:30	Increasing Women's Participation in Hunting	Jennifer Zavaleta Cheek, Ph.D. (SDSU)
	3:00	Telling The Story of The Hunt in Photos and on Social	Nate Akey & Aaron Black-Schmidt (PF & QF)
	3:30	Five Stories from Hunters Across the U.S.	Mark Norquist (Modern Carnivore)
	4:00	Getting More Out of Your Birds and Q&A with Hank	Hank Shaw (Hunt Gather Cook)
	5:00	Finding Friends to Hunt with and Land to Hunt	Tony Jones, Ph.D. (@thereverendhunter)
	5:30	Fueling Your Bird Dog to Optimize Performance	Dr. RuthAnn Lobos (Purina)
SATURDAY	10:00	Finding Friends to Hunt with and Land to Hunt	Tony Jones, Ph.D. (@thereverendhunter)
	10:30	Telling The Story of The Hunt in Photos and on Social	Nate Akey & Aaron Black-Schmidt (PF & QF)
	11:00	Increasing Women's Participation in Hunting	Jennifer Zavaleta Cheek, Ph.D. (SDSU)
	11:30	Field First Aid for Your Hunting Dog	Dr. RuthAnn Lobos (Purina)
	12:00	Five Stories from Hunters Across the U.S.	Mark Norquist (Modern Carnivore)
	12:30	E-Scouting for Public Land Pheasants	Ben Brettingen (onX Hunt)
	1:00	Getting More Out of Your Birds and Q&A with Hank	Hank Shaw (Hunt Gather Cook)
	2:00	A Woman's Path to the Uplands	Tina Dokken (Youtube: Unleashed)
	2:30	Not Ours Just Our Turn	Doug Duren (@dougduren)
	3:00	The Importance of Diversifying Access in Conservation	Chris Kilgour (Color in the Outdoors)
	3:30	How To Find and BE An Outdoor Mentor	Nick Hoffman (Ugly Duckling Entertainment)
	4:00	Falconry For Upland Birds	Tyler Sladen (@quail_hawk)
SUNDAY	10:00	Falconry For Upland Birds	Tyler Sladen (@quail_hawk)
	10:30	E-Scouting for Public Land Pheasants	Ben Brettingen (onX Hunt)
	11:00	Not Ours Just Our Turn	Doug Duren (@dougduren)
	11:30	A Woman's Path to the Uplands	Tina Dokken (Youtube: Unleashed)
	12:00	Bird Dog, Family Dog	Tom Carpenter (PF)
	12:30	Finding Friends to Hunt with and Land to Hunt	Tony Jones, Ph.D. (@thereverendhunter)
	1:00	Fueling Your Bird Dog to Optimize Performance	Dr. Ruth Ann Lobos (Purina)
	1:30	The Importance of Diversifying Access in Conservation	Chris Kilgour (Color in the Outdoors)
	2:00	How To Find and BE An Outdoor Mentor	Nick Hoffman (Ugly Duckling Entertainment)



PHEASANTS FOREVER AND QUAIL FOREVER'S
YOUTH VILLAGE

FEATURED ACTIVITIES



THE PLACE FAMILIES KEEP COMING BACK TO!

All of the efforts made today by Pheasants Forever and Quail Forever have little impact without future conservation leaders taking a stand for wildlife conservation. In an effort to engage and educate those future conservation leaders, our organization is dedicated to working with members, chapters and conservation partners to provide opportunities for youth and their families to share our outdoor traditions.

Visit our Youth Village and get those boys and girls busy at the show! Featured activities at the Village are profiled at right.

A special thank you to these organizations and exhibitors for helping provide activities at Youth Village throughout the weekend: South Dakota Game, Fish & Parks – The Outdoor Campus Sioux Falls, Sioux County Conservation Board, Iowa Association of Naturalists, Project Healing Waters, and Simply Ever After Entertainment, LLC.

SPONSORED BY



HANDS-ON HABITAT ACTIVITIES



FACE PAINTING



INDOOR BB GUN RANGE



ARCHERY RANGE



REPTILES



COLORING AND CRAFTS



ANIMAL FURS



FLY TYING

FAMILY DAY

SUNDAY, MARCH 3, 2024

PRESENTED BY

All kids 16 and under receive **FREE** show floor admission on Sunday, March 3!

It's a great day to check out the Youth Village with a special family photo booth onsite, treat stations throughout the show for kids 16 and under! Cookies, popcorn, and more, along with lots of great kids activities and hands-on projects!

Family Day Activities in the First PREMIER Bank Booth #2012:

- FREE POPCORN
- SELFIE PHOTO BOOTH



First 500 Families get a **FREE** Spunky Pup Fly & Fetch Launching Pheasant from First PREMIER Bank and PREMIER Bankcard!



← SCAN TO BECOME A YOUTH MEMBER OF PF & QF

FEATURED SPEAKERS

HABITAT HELP DESK

SPONSORED BY



AND SEMINAR STAGE SCHEDULE

The Habitat Help Desk is an area of the show floor dedicated to helping everyone create and manage upland wildlife habitat. We help farmers and landowners meet their conservation and habitat goals on their property. Consult with trained wildlife biologists to gain insights into management activities, as well as what local, state and federal voluntary conservation programs may be available for your property. But you don't have to be a landowner to come, visit, ask questions and go away with ideas for creating or managing upland habitat on any scale. We also help with strategies for managing existing habitat with prescribed burns, grazing, mowing, brush and tree cutting, and other approaches. We are here to help with your habitat!

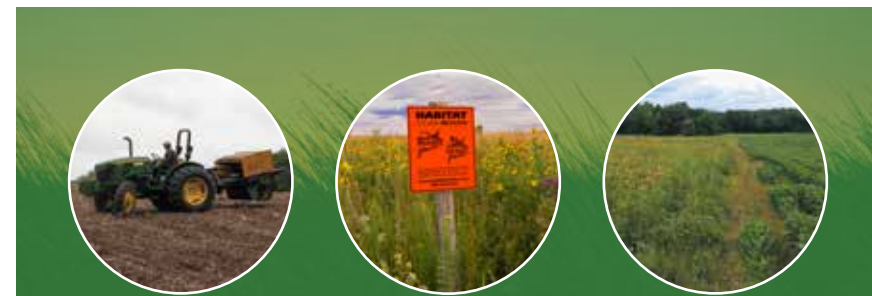

WHY HABITAT?

Two factors affect pheasant and quail populations above all others — habitat and weather. While we can't control the weather, we can influence the quality and quantity of upland habitat. Habitat is what supports strong and healthy pheasant and quail populations — and many other species of upland wildlife such as whitetails, monarch butterflies, honeybees and prairie songbirds — for the long term.



DOUG DUREN

Doug Duren is a passionate land manager, conservationist, farmer and hunter from Cazenovia, Wisconsin. About the land, he preaches, "It's not ours. It's just our turn."



USFWS PARTNERS PROGRAM

Since 1987 the USFWS Partners Program has been assisting landowners in the restoration and enhancement of wildlife habitat, providing both technical and financial assistance. Partners staff custom-design projects to meet landowners' needs.



HABITAT HELP DESK RECEIVE A PERSONALIZED CONSERVATION PLAN

Bring a legal description of your property or be able to pinpoint your property's exact location on a map. Then sit down with a trained biologist from PF & QF to review your property and learn what financial and technical assistance programs may be available. You'll leave with knowledge, insight and a plan to help accomplish your habitat goals.

	TIME	TOPIC	SPEAKER(S)
FRIDAY	1:00	Challenges of Effective Management on Small Acre Habitats	Travis Rogers and Mike Retterer (PF & QF)
	1:30	Integrating Pheasant and Waterfowl Conservation	Kurt Forman (USFWS)
	2:00	Healthy Pollinator Habitat and How to Create It	Catherine Beall (PF) and Rae Powers (Xerces)
	2:30	Habitat: Planning to Implementation - How to	Doug Duren
	3:30	Yield Data Guides Conservation Adoption	Stephanie Nelson (PACS) and Hallie Uhlig (FBB)
	4:00	Prescribed Fire in the Great Plains - Panel	Pete Bauman (SDSU), Dirac Twidwell (UNL), Sean Kelly (SDSU), Cody Grewing (Audubon), Kendall Hettick (PF)
SATURDAY	10:00	Habitat: Planning to Implementation - How to	Doug Duren
	11:00	The Future of Farm Bill Conservation Programs	PF and Partners Panel
	1:00	Integrating Pheasant and Waterfowl Conservation	Kurt Forman (USFWS)
	1:30	Healthy Pollinator Habitat and How to Create It	Catherine Beall (PF) and Rae Powers (Xerces)
	2:00	Challenges of Effective Management on Small Acre Habitats	Travis Rogers and Mike Retterer (PF & QF)
	2:30	Yield Data Guides Conservation Adoption	Stephanie Nelson (PACS) and Hallie Uhlig (FBB)
	2:30	Pheasant Predators and Habitat	Nicole Davros, MN DNR
	3:00	Prescribed Fire in the Great Plains - Panel	Pete Bauman (SDSU), Dirac Twidwell (UNL), Sean Kelly (SDSU), Cody Grewing (Audubon), Kendall Hettick (PF)
SUNDAY	10:00	Prescribed Fire in the Great Plains - Panel	Pete Bauman (SDSU), Dirac Twidwell (UNL), Sean Kelly (SDSU), Cody Grewing (Audubon), Kendall Hettick (PF)
	11:00	Healthy Pollinator Habitat and How to Create It	Catherine Beall (PF) and Rae Powers (Xerces)
	12:00	Habitat: Planning to Implementation - How to	Doug Duren
	1:00	Yield Data Guides Conservation Adoption	Stephanie Nelson (PACS) and Hallie Uhlig (FBB)
	1:30	Challenges of Effective Management on Small Acre Habitats	Travis Rogers and Mike Retterer (PF & QF)



(External Dimensions: 20.4" W x 14.8" D x 11.3" H)

Exclusive

LIFE MEMBER GIFT

Limited edition
PF or QF YETI GoBox 30,
plus a 1 in 10 chance at a \$500
show floor gift certificate!

VISIT OUR ELITE
MEMBER BOOTH AT
THE SHOW FLOOR
ENTRANCE TO LEARN
MORE AND SIGN
UP TODAY!

\$1,000 gift provides membership for life, and it displays your unwavering commitment to the PF & QF wildlife habitat conservation mission.

Life Member Benefits Include:



Exclusive
Life Member
window decal



Framed Life Member
Certificate and
recognition in the
*Journal of Upland
Conservation*



Lifetime subscription
(5 issues annually) to
the *Journal of Upland
Conservation*

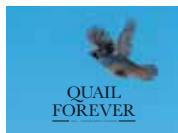

Lifetime delivery
of the PF or QF
13-Month Calendar
(mailed every fall)



Lifelong invitations
to PF & QF events
and special gatherings



SCHEELS

PARTNERS WITH A PURPOSE



VISIT THE PHEASANT FOREVER & QUAIL
FOREVER STORE POWERED BY **SCHEELS**
TO CHECK OUT THE SHOW SPECIALS
ON BRANDED MERCHANDISE



[SCHEELS.COM/PFSTORE](https://scheels.com/pfstore)



[SCHEELS.COM/QFSTORE](https://scheels.com/qfstore)

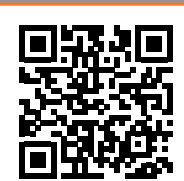

← SCAN TO BECOME A
PF LIFE MEMBER NOW!
pheasantsforever.org/lifemember



← SCAN TO BECOME A
QF LIFE MEMBER NOW!
quailforever.org/lifemember

Find a location near you
scheels.com/stores

Connect with us @scheelsoutdoors

VISIT THE WOMEN ON THE WING



Lounge

NEW at 2024 National Pheasant Fest & Quail Classic!

A lounge space on the show floor providing a relaxed environment for women who love the great outdoors, hunting and conservation, to connect and share stories!

Giveaways throughout the weekend!

LOCATION:

Corner of the Denny Sanford PREMIER Center building, near booth 902.

Meet noteworthy women throughout the weekend including industry professionals, biologists and artists!

EVENTS:

WOTW EVENTS AND OPPORTUNITIES to get involved

OPPORTUNITIES TO NETWORK and connect with other sportswomen interested in the uplands

TIPS ON PICKING the right hunting gear, bird dog training tips, habitat projects, and more!

Featured Guests & Times posted at the Lounge



SPORTSMAN'S GUIDE

LIMITED EDITION PHEASANT FEST SHIRT



BOOTH # 1413/1512
IN ROOSTER ROW NEXT TO IRISH SETTER BOOTS



\$20

BUYER'S CLUB MEMBERS PAY \$15

EVERY PURCHASE SUPPORTS THE "BUILD A WILDLIFE AREA" INITIATIVE



Second Century Habitat Fund partners with producers and landowners to conserve and expand healthy habitat for pheasants and other wildlife habitat.

**FOR US,
FOR THEM.**

Our need to raise financial support is stronger than ever.

We can't create more land, but by investing in habitat we can make a difference for all South Dakotans.

DONATE NOW

➤ SDHabitatFund.org



Your Online Upland Headquarters

- facebook.com/quailforever | facebook.com/pheasantsforever
- instagram.com/quail_forever | instagram.com/pheasants_forever
- x.com/quail4ever | x.com/pheasants4ever
- Download *On the Wing Podcast* everywhere podcasts are available

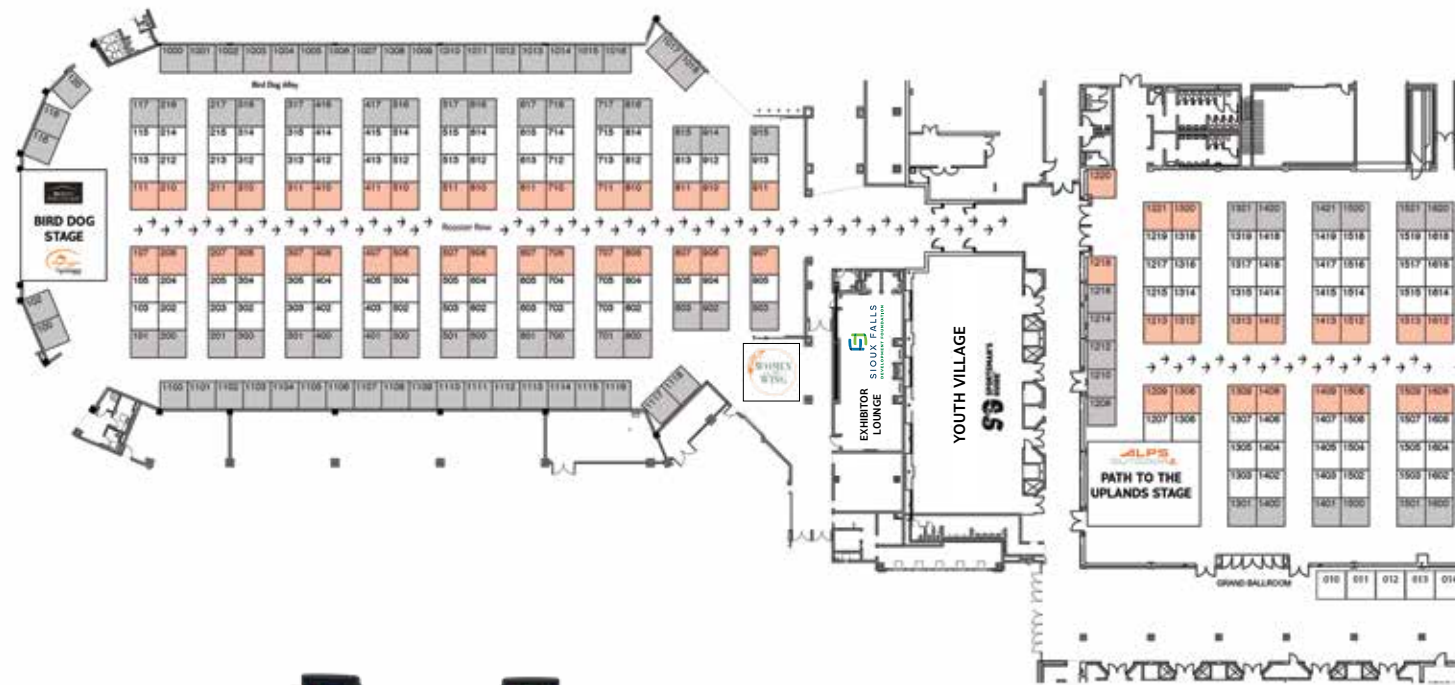

MEMORIES LAST A LIFETIME, SO SHOULD YOUR MEMBERSHIP

Visit our Elite Member booth at the show floor entrance to become an elite member, and make a substantial impact on wildlife habitat and our upland hunting traditions.

EXCLUSIVE LIFE MEMBER GIFT

Limited edition PF or QF YETI GoBox 30, plus a 1-in-10 chance at a \$500 Show Floor Gift Certificate!

SHOW FLOOR RAFFLE

You Win... You Choose!

ULTIMATE UPLAND
RAFFLE

SCHEELS
Partners with a Purpose

\$20 PER TICKET

YOU WIN YOU CHOOSE! A
WINNER IS SELECTED FROM
EVERY 50 TICKETS SOLD.

PRESENTED BY **SCHEELS**

KNOW WHERE YOU STAND RAFFLE



\$100
PER TICKET

300
TICKETS SOLD

Each Ticket Purchased Receives a
FREE onX Elite Membership and
a PF & QF Upland Feather
Water Bottle

FOR A CHANCE TO WIN A POLARIS SPORTSMAN
570 PREMIUM ATV + \$1,000 CREDIT TO KOLPIN.COM



Prize may vary
from Picture



ON **onX** HUNT **POLARIS**



PROUD
SUPPORTER
OF PHEASANTS
FOREVER & QUAIL FOREVER

BOTTOMS UP FOR BIRDS

Leinenkugel's

THIRSTY?
VISIT THE
LEINIE LODGE IN
CHIPPEWA FALLS,
WISCONSIN



SCAN
FOR
BEER,
TOURS,
EVENTS,
SHOP,
& MORE.

CELEBRATE RESPONSIBLY™ | ©2024 JACOB LEINENKUGEL BREWING COMPANY, CHIPPEWA FALLS, WI

FEATHERED

50



50

RAFFLE

THE BIGGER THE JACKPOT,

THE BIGGER THE IMPACT!

FRIDAY: 8am – 7pm

SATURDAY: 8am – 6pm

SUNDAY: 8am – 4pm



Scan the QR code to enter or visit

pheasantsforever.org/5050



ONLINE SILENT AUCTION



SCAN THE QR CODE WITH YOUR PHONE CAMERA TO CHECK OUT THE ITEMS AND START BIDDING!

Hunting & fishing gear, trips, wild game cooking, firearms and more!



Be A Leader! Complete An

ELITE MEMBER SLAM



You can complete an Elite Slam by securing your Pheasants Forever Membership, Quail Forever Membership, and a Dog Membership at the Life Member Level, Patron Member Level, or Gold Patron Member Level.

Completing an Elite Member Slam helps Pheasants Forever and Quail Forever make a greater impact. Not only will critical upland wildlife habitat see long-lasting results from your increased support, but you will become part of a prestigious group of supporters committed to helping the organization make more pheasants and quail.

ACHIEVE THE SLAM IN EACH OF THESE THREE ELITE MEMBER LEVELS:

Life Member Slam :: Patron Member Slam :: Gold Patron Member Slam

Complete your ELITE SLAM today by visiting the Elite Member Booth at the show floor entrance.



← SCAN HERE TO ENROLL pheasantsforever.org/eliteslam

HUNTER MENTOR CHALLENGE

ALPS OUTDOORZ



Take someone new out this season, tell us about it and the two of you will be entered to win a guided bird hunt!

STEP 1: Commit to taking a new or lapsed hunter into the field this fall

STEP 2: Take a photo or short video of your hunt together – any game species counts!

STEP 3: Enter your hunt to win a 3-night, 2-day guided pheasant and quail hunt at Harpole's Heartland Lodge in the fall of 2024!



« SCAN TO PLEDGE
pheasantsforever.org/mentorpledge

UPLAND BIRD TECHNICAL AND STUDENT POSTER SESSIONS

Saturday, March 2 ONLY!

Denny Sanford PREMIER Center
Rooms: 8 - 10

Hear from our experts in upland research and learn from up-and-coming biologists sharing their latest research!

UPLAND BIRD TECHNICAL SESSIONS

9am-11am and 1pm-3pm

STUDENT POSTER PRESENTATIONS

11am-12pm and 3pm-4pm



OPEN TO THE PUBLIC & FREE ADMISSION!



HUNTING

Just Like The Good Ol' Days

AVAILABLE

- Fully Catered Hunts
- Self Guided Hunts
- Corporate Meeting Areas

For more information call:
Jake (605) 994-7588
Shelley (605) 994-7589



dakotahuntingfarms.com

(800) 356-5281

PO Box 98 Hecla, SD 57446



POLLINATOR PATHWAY

FEATURED ACTIVITIES

Back by popular demand, the Pollinator Pathway at 2024 National Pheasant Fest & Quail Classic will again provide information on popular pollinator species, community science research projects, fundraising campaigns, and habitat programs being implemented to provide quality habitat for a host of grassland and wildflower-dependent species including pollinators, upland birds and other wildlife. In addition, there will be several hands-on activities available to educate participants of all ages on the value of pollinating insects and the habitat they call home.

At the Pollinator Pathway in 2024, participants will have the opportunity to replicate the monarch butterfly migration. Learn about the trials and tribulations of the monarch's annual 2,000-mile journey.

Stop by, visit with our staff, and get ideas and insights for pollinator plantings from your backyard to the back 40!



POLLINATOR ACTIVITIES



HABITAT PROGRAMS



EDUCATION



TECHNICAL ASSISTANCE



Pheasants Forever and Quail Forever has emerged as a national leader for conserving habitat critical for monarchs and pollinators. In the last eight years, we have developed seed mixes that have included milkweed for 32,592 projects across the country. Of those projects, we have impacted 318,134 acres and planted 1.17 billion milkweed seeds. In addition, Pheasants Forever and Quail Forever employ 236 field biologists throughout the country. These biologists meet with 30,000+ landowners per year, impacting over 1.4 million acres per year that benefit pollinators and gamebirds.

More dogs ride in a Ruff Land™ than any other performance kennel!

Why? Because Ruff Land™ Kennels are designed to both protect your dog and make your kenneling experience better!

Built safe like a performance race car

Most kennels are simply not strong enough to protect your dog in an impact situation. Ruff Land's one-piece rotomolded construction is extremely strong.



The walls, top and floor on Ruff Land™ Kennels also have built-in flexibility which absorbs energy that would otherwise be transferred to your dog. This is where the "stiff", two-walled plastic kennels, which claim to be safer, fail. They may not break, but when your dog hits the side of the kennel, there is no give as there is with a Ruff Land™.



Kennel walls are well-vented, angled for airflow

The sidewalls on all Ruff Land™ kennels feature a series of vent holes. These vent holes ensure proper air circulation for your dog. Ruff Land™ took this one step further by tapering the side walls so that the vent holes will never get plugged, even if you slide the kennel up against a wall or some other flat sided object.

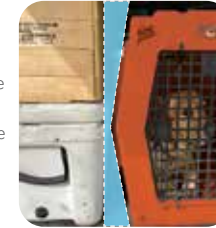

Doors open both ways; no annoying travel rattle

The doors on a Ruff Land™ Kennel have latches on both sides so they open either direction. And, unlike the doors on other kennels, Ruff Land's Rattle-Less design means no annoying travel rattle.



Ruff Land™ is proud to be the Official Kennel of Pheasants Forever® and Quail Forever®!

Ruff Land™
PERFORMANCE KENNELS

Customize your options and accessories at RuffLandKennels.com



Ramkota Sioux Falls, Grand Rushmore Hall 9:00 pm CST

JOIN US FOR A NIGHT OF LIVE MUSIC, CAMARADERIE, AND CONSERVATION.

You'll have the chance to win a variety of upland gear with free pull tabs, share a beverage courtesy of Leinenkugel's and learn more about how the new PATH program is impacting walk-in access across South Dakota's landscape. Live music by the Dam Jammers.



HONOR THEIR COMMITMENT

Visit our Elite Member booth at the show floor entrance to honor your dog with a Dog Life Membership.



Claim a **FREE** Mud River Dog Handler's Bag or a \$100 Show Floor Gift Certificate.



← SCAN HERE TO ENROLL
pheasantsforever.org/doglife



← SCAN HERE TO ENROLL
quailforever.org/doglife

JOHN DEERE REWARDS

Pheasants Forever and *Quail Forever* members are now eligible for valuable discounts on equipment such as compact utility tractors through the free **John Deere Rewards** program.

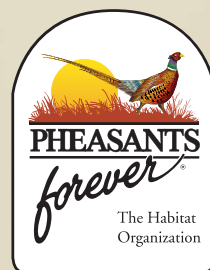

SIGN UP TODAY AT

www.JohnDeere.com/Pheasants
www.JohnDeere.com/Quail



JOHN DEERE

A STRETCH OF FIELD REACHES FURTHER THAN YOU KNOW.



Our community's success rests on your back. And there is BASF support that lives nearby, in the field and on main street ready to help. Learn more at agriculture.basf.us. **BASF. Helping you do the biggest job on earth.**

BASF
We create chemistry

© 2023 BASF Corporation.

FEDERAL PREMIUM

PRAIRIE STORM



Premium copper-plated lead



FLITESTOPPER pellets



FLITECONTROL FLEX wad



NOW WITH FLITECONTROL FLEX

The skies are ready to open. Federal Premium® Prairie Storm® uses the updated FLITECONTROL FLEX® wad and a mixed payload of standard and FLITESTOPPER® pellets to produce an inescapable torrent of shot through both ported and standard upland chokes. Now available in the complete line of 12-, 16-, 20- and 28-gauge loads,

THERE'S NO SHELTER.

BUY NOW AT FEDERALPREMIUM.COM